

# Gainsborough's Annual Assembly of the Town Meeting

---

APRIL 2024

# Town Mayor's Welcome

---

COUNCILLOR CAZ DAVIES



# Welcome to:

---

West Lindsey District Council

Lincolnshire County Councillor Richard Davies

Gainsborough Trinity Foundation

Night Light Café

Bearded Fishermen

The Salvation Army Food Bank

Connexions Community Hub

North Notts & Lincs Community Rail Partnership

Gainsborough Changing Places

Greener Gainsborough

Shaw Trust

# Minutes of 2023 Town Public Meeting & Matters Arising

---

COUNCILLOR CAZ DAVIES





# Town Mayor's Report

---

COUNCILLOR CAZ DAVIES





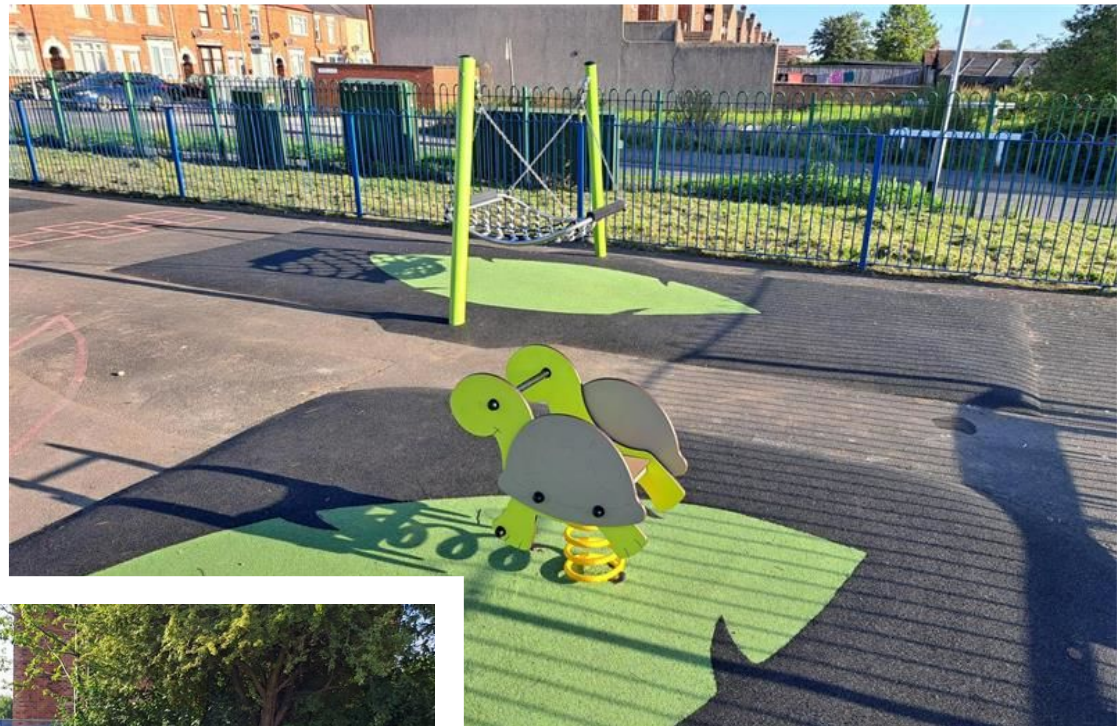





**GAINSBOROUGH TOWN COUNCIL**

IS PLEASED TO AWARD

*Claire Moore*

**CITIZEN OF THE YEAR 2023**

In recognition of her work with the Gainsborough Night Light Cafe and running of warm space projects throughout the town.

Claire's nominations highlighted her kind, caring and approachable nature, clear to all through her work, volunteering and helping people of all ages.

An asset to Gainsborough - this award recognises Claire Moore for going above and beyond.

*Rachel Allbones*

INTERIM TOWN CLERK

# Town Mayor's Report

---

COUNCILLOR CAZ DAVIES



# Awarded Community Grants

---

<b>Applicant</b>	<b>Amount Awarded</b>	<b>Date Awarded</b>
Cub Scouts	£1000	14/03/2023
2 <sup>nd</sup> Gainsborough Guides	£1000	13/06/2023
Connexions 4 Youth	£1000	12/09/2023
Hillcrest Early Years Academy	£1000	12/03/2024
Morton Festival	£730	12/03/2024

# 2023-24 Mayoral Community Visits

EAST MIDLANDS IN  
BLOOM  
COMPETITION

REMEMBRANCE  
SUNDAY

HILLCREST  
GARDENS  
OPENING

GERMAN  
EXCHANGE VISIT -  
QEHS

GAINS CHORAL  
SOCIETY  
PERFORMANCES

CYCLING CLUB  
PICNIC

STEPPING STONE  
8<sup>TH</sup> BIRTHDAY PARTY

GAINSBOROUGH  
IN BLOOM

HILLCREST SUMMER  
FAIR

WHAT MATTERS  
TO YOU, NHS  
LINCOLNSHIRE

LINCOLNSHIRE &  
NOTTINGHAMSHIRE  
AIR AMBULANCE  
EVENING

EFSD ROCKS THE  
COUNTRY

LIZZIE! THE  
MUSICAL, TRINITY  
ARTS CENTRE

WARRENS WOOD  
SPAR STORE  
OPENING

CHRISTMAS DAY  
LUNCH

**LEVELLING  
— UP —**



INVEST | GAINSBOROUGH

---

**West Lindsey Levelling Up Fund**



# INVEST | GAINSBOROUGH

18<sup>th</sup> April 2024 – Gainsborough Town Council



**LEVELLING  
— UP —**





INVEST

GAINSBOROUGH



Cinema



Townscape Heritage Initiative



Market Place Re-design



Improved Signage



Enhanced Green Space



Bus Station Refurbishment



Made possible with

Heritage  
Fund

**LEVELLING  
— UP —**



UK Government

Work completed so far



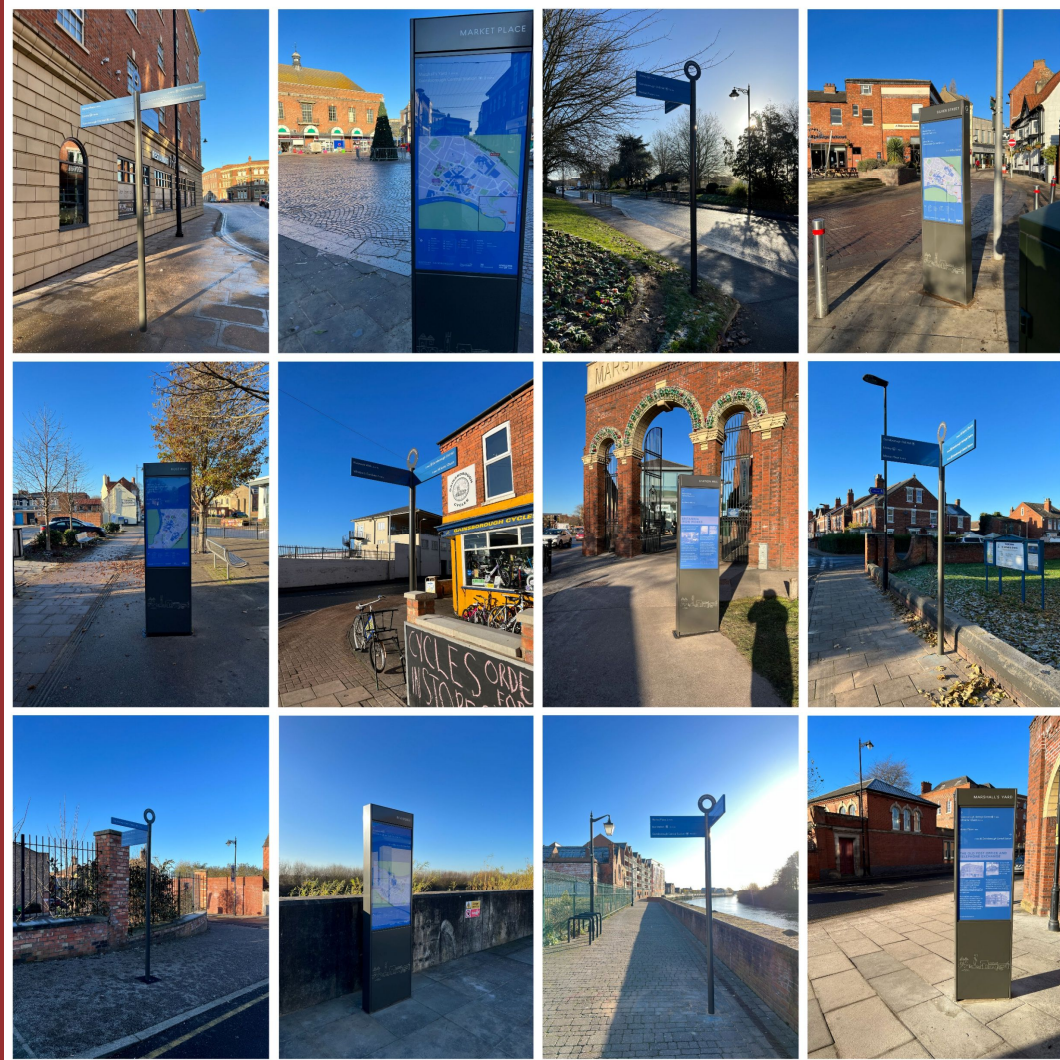

# Installation of new signs December 2022



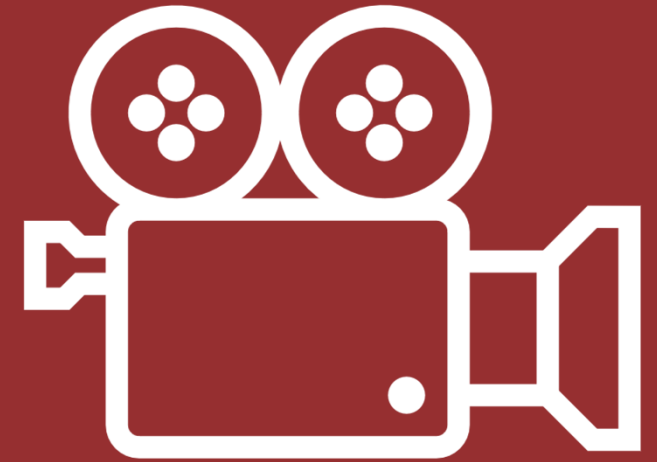

Lindsey Centre demolition  
June 2023





## 5-7 Market Place



Before



After



Complete Properties:

5-7 Market Place  
27-29 Lord Street  
7 Lord Street

March 2024





Bus Station refurbishment  
March 2024







# Whitton Gardens refurbishment March 2024



# Upcoming milestones

Please note various images are artist impressions





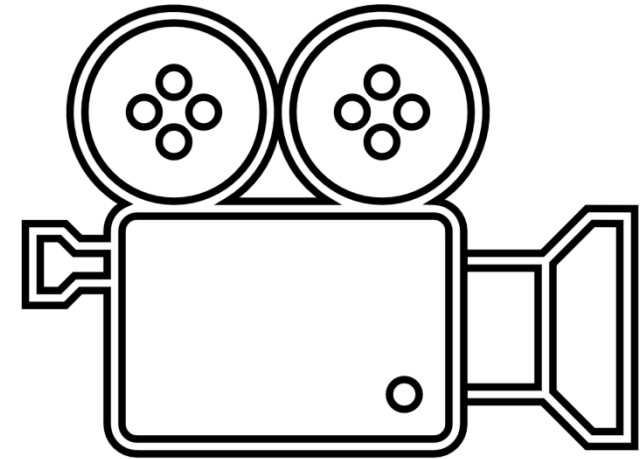

Cinema Construction  
April 2024



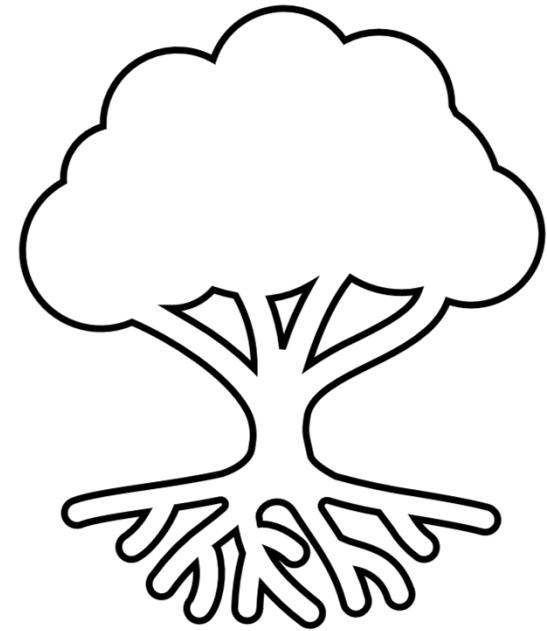

# Café Procurement and Construction June 2024





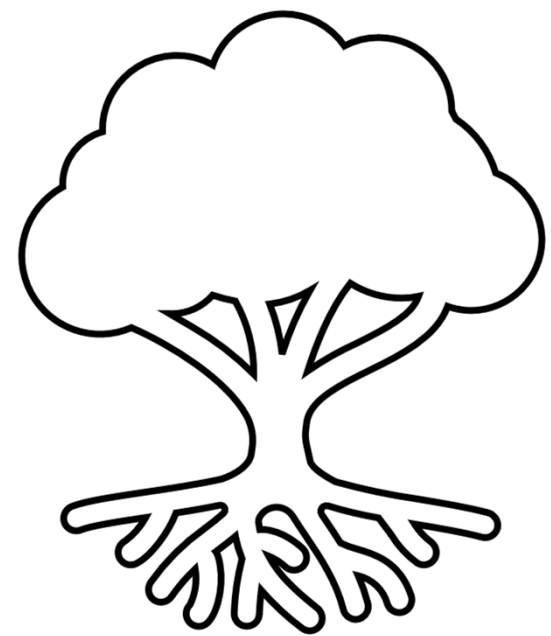

Baltic Mill Procurement  
and construction  
September 2024



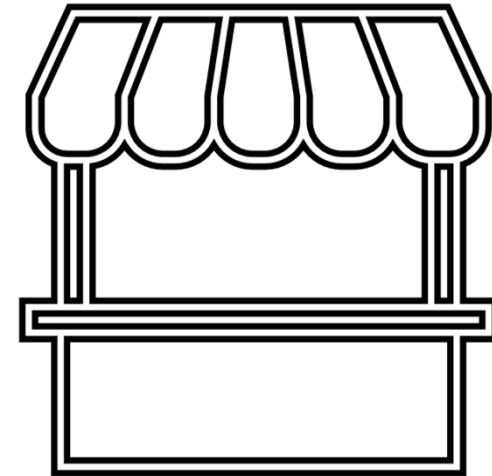

Market Place Phase 1  
September 2024



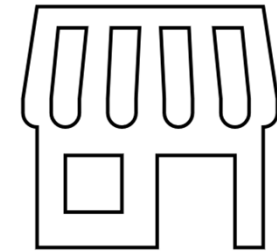

March 2025

### Potential complete properties:

37 Lord Street

24 Market Street

1-5 Lord Street

Gainsborough Town Hall

25 Lord Street

34-36 Market Place

49 Lord Street

1 Silver Street

5 Silver Street

10 Silver Street

17-19 Silver Street

9-11 Market Place

31 Market Place

11-15 Silver Street

16 Silver Street

39 Lord Street

27 Market Place

38 Market Place

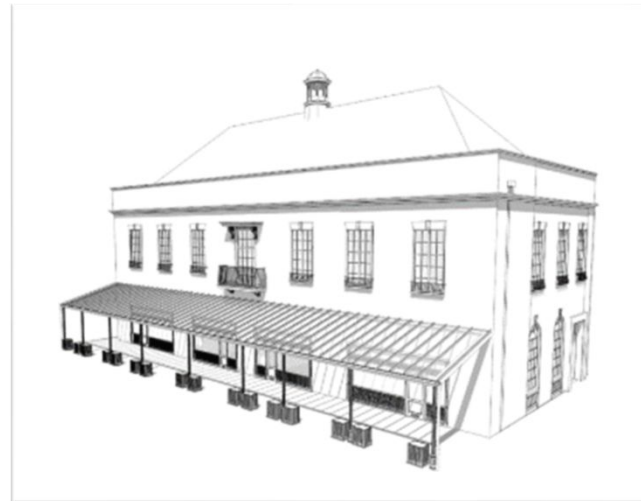



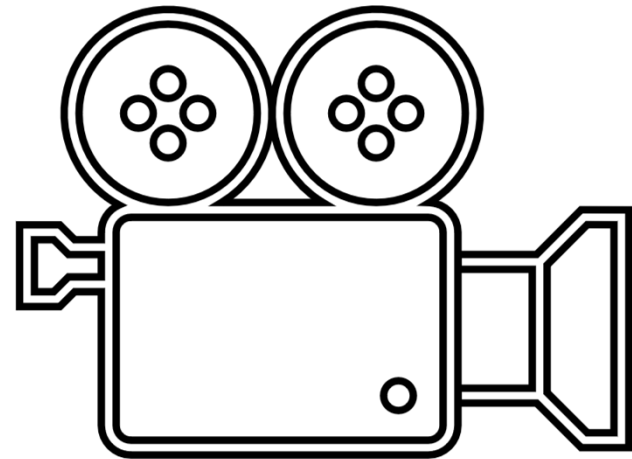

Cinema completion  
Summer 2025

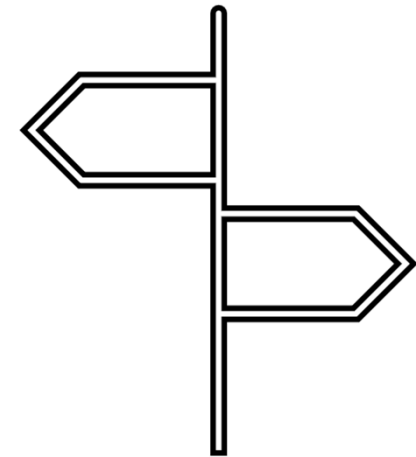
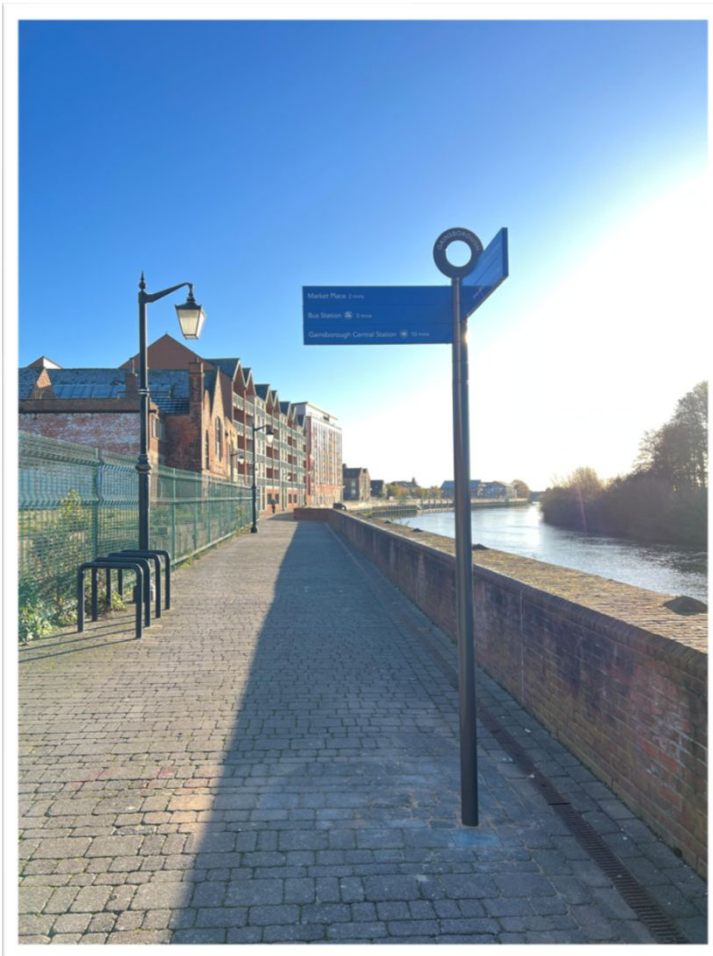

Signage update  
Summer 2025





## Gainsborough Farmers and Craft Markets 2024 Themes and Activities

11 May Dinosaur

8 June Young Traders

15 June GO Festival

13 July Heritage Skills Fair

10 August Olympics

14 September WordFest

12 October Halloween Party

9 November 1940s Remembrance

15 and 16 November Christmas Lights Festival

14 December Christmas





**Thank you.**  
**Are there any questions about our Levelling Up  
Fund Programme?**





# LCC - Cllr Richard Davies

---

GAINSBOROUGH TRANSPORT STRATEGY

# **Gainsborough**

## **Highways & Transport**

18th April 2024



# Lincolnshire

- 5500 miles of road / 4th largest network in UK
- £45M road maintenance
- 40,000 work orders per year
- £4M public transport: bus passes
- £35M school's transport: 25k children daily transported
- Major infrastructure:
  - North Hykeham Relief Rd £150M
  - Grantham southern relief road £160M

# Maintenance – 3 Year Summary

- LCC carriageway schemes - total £4.16m
- Foxby Lane S278s - £2m
- Pedestrian crossings - £16.4k – Morton Rd
- TROs: Church Street, Trinity Street, Park Springs, Corringham Rd
- Carriageway:
  - 1900 repairs
  - 14 Minor Works jobs
  - 301 kerb/channel
- Footway:
  - 296 footway defects made safe.
  - 33 patching/kerbing
  - 39 debris removal
- Vegetation:
  - 45 vg clearance
  - 72 tree works
- Drainage:
  - 24 drainage investigations/repairs
- Street Furniture repairs:
  - 41 repairs to bollards, signs, railings.



# Maintenance - 12mth Plan

- Carriageway - estimated £2.4m Town spend
- A631 Corringham Village Scheme £1.4m
- Footways - 49 sites for micro-surfacing this year
- Street Lighting - £102k - Whites Wood Lane





# Public Transport - Rail

## COVID Impact on Services:

- Sheffield to Gainsborough Central Service suspended
- Lincoln to Sheffield/Leeds service frequency was

## Current Service Status:

- Funded by Central Government, with challenges in regional service recovery.
- Additional services must be cost-neutral or have a business case for funding.
- Lincoln to Sheffield/Leeds service has resumed, but journey times have increased due to additional stops.
- Sheffield to Gainsborough Central partially resumed, then fully withdrawn; Brigg route operates on Saturdays only.

## Services by Northern Trains:

- Lincoln to Leeds service operates 16/17 trains daily, with reduced frequency on Sundays.
- A new weekday service from May 2023 links Sheffield, Gainsborough Central, and Cleethorpes with no weekend service.

## Services by East Midlands Trains:

- Doncaster to Lincoln via Gainsborough Lea Road operates 5 trains daily on weekdays and Saturdays.

## Future Planning & Infrastructure:

- Network Rail published the Lincolnshire Strategic Advice for network planning.
- Ongoing stakeholder engagement for planning and business case development.
- Gainsborough Lea Road platform renewal is delayed, which is part of the Control Period 6 scheme.

## Community Initiatives:

- Community rail partnership reactivates X90 Saturday bus service for the summer.
- Funding secured for 10 weeks of service from June 29, coinciding with Cleethorpes Armed Forces Day.



# Public Transport - Bus

## **S106 Funding Allocation (2021/22):**

- Gainsborough was awarded £50k for bus stop and shelter enhancements.

## **Bus Stop Improvements:**

- New marked bus stops on Corringham Road
- Upgrades to existing bus services on Corringham Road due to recently enhanced town service.

## **Bus Shelter Upgrades:**

- Working with Gainsborough Town Council:
  - A new shelter on Beaumont Street.
  - Replacement shelters at Lea Road Station (2), Shakespeare Street, Gordon Street, and Church Street.

## **Service Frequency Increase:**

- Gainsborough in-town bus service frequency increased fourfold, from 1 to 4 buses per hour.
- Expanded service coverage to new areas of the town, including Morrisons.

## **Technology Integration:**

- Introduction of an app-based booking system for CallConnect, facilitating easy self-service access to bus services for residents.
- Real-Time information boards being rolled out across the network.





# Gainsborough Transport Strategy

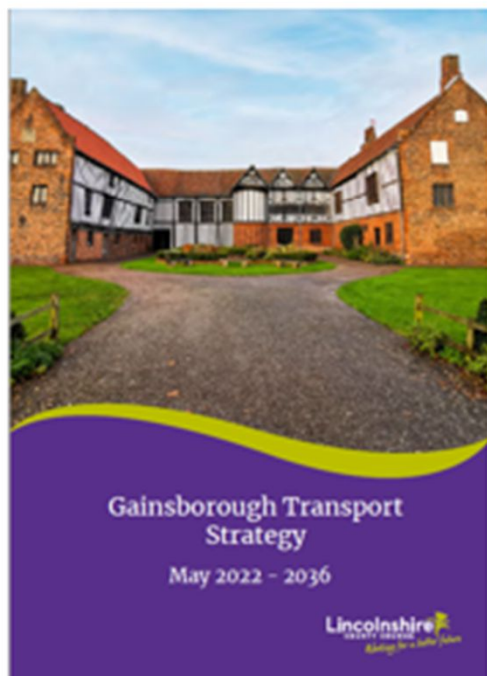

**Goals:** To support economic growth, improve access to services, and assist in the transition to net zero emissions, making travel more sustainable and efficient.

## **Key Challenges**

- Increased housing
- Employment opportunities
- Pinch pints

## **Strategic Objectives:**

- Enhance the town centre to make it safer and more attractive.
- Improve facilities for walking and cycling.
- Investigate and possibly enhance key traffic junctions.
- Develop Gainsborough's train and bus stations into mobility hubs.

## **Proposed Solutions**

- Mobility hubs that provide a range of transport options.
- Improved streetscape and pedestrian access
- Improve connectivity: e.g. Bridge Rd / A631 corridor

**Funding and Support:** Limited and developer-led

# Useful Links



**fixmystreet.lincolnshire.gov.uk**  
Reporting all highways-related issues



**Roadworks.org**  
All road space bookings



**Lincolnshire.gov.uk**  
All information about LCC inc  
Find My Councillor

# Questions?



REGISTERED CHARITY NUMBER: 1168775

# Gainsborough Trinity Foundation

---

# Gainsborough Trinity Foundation



REGISTERED CHARITY NUMBER: 1168775

**Richard Cooper**  
**Foundation Manager**  
**18<sup>th</sup> April 2024**



# Gainsborough Trinity Foundation



Who are we?.....

.....A Sport and Wellbeing registered Charity!

***“Aimed at using the power of sport and recreational activities to engage with individuals and groups, to help combat a range of social challenges and community issues”***



## History of Gainsborough Trinity Foundation

- Established in 2015 in a portacabin at the Northholme
- One employee
- Charitable status on 15<sup>th</sup> August 2016
- Relocated to Roses Sports Ground, Gainsborough in 2019
- Currently 22 employees



REGISTERED CHARITY NUMBER: 1168775

# Gainsborough Trinity Foundation

## What we do.....

- **Two arms to the charity:**
- **Community Initiatives & Bar, Catering and Event Space**
- **Youth Engagement – two projects funded by The National Lottery**
- **Disability Sports Project – funded by BBC Children in Need**
- **Schools Sports Programme – 8 schools per week**
- **Adult Learning Provision funded by Lincolnshire County Council**
- **HAF/School Holiday Activities – part funded by Lincolnshire County Council**
- **Night Light Café – mental health provision funded by the NHS**
- **32 Football Teams, 6 Rugby Teams, Bowls Club & Croquet Club**
- **Footfall – between 1,500 & 2,000 visitors per week!!!**



# Gainsborough Trinity Foundation

## What we do (cont.).....

- Two arms to the charity:
- **Community Initiatives & Bar, Catering and Event Space**
- Fully Licensed Bar (The Venue)
- Catering provided for events and social gatherings
- Event space for community groups to meet
- Event space for functions and corporate meetings
- Event space for parties, weddings, funerals, christenings, baby showers etc



# Gainsborough Trinity Foundation

## Opportunities:

- To further develop the Roses Sports Ground site –
- New office space
- New classroom area
- New playing surface for the sand based astroturf
- Additional changing rooms
- Refurbishment of existing facilities
- Grow our community initiatives

## Challenges:

- Aging equipment and infrastructure of existing site
- Expense of maintaining a 16-acre site
- Energy costs and escalating prices





# Gainsborough Trinity Foundation



REGISTERED CHARITY NUMBER: 1168775

Any questions?



Night Light  
Cafe

---

# What is a Night Light Café?

A Night Light Cafe is a safe space for people to come, they can offer non clinical mental health support. All Night Light Cafes are run by trained volunteers who are there to listen mostly in the evening when community mental health teams are not readily available.



**In February  
Gainsborough Night  
Light Café supported  
23 people.**



# What do we do at Gainsborough Night Light Café.

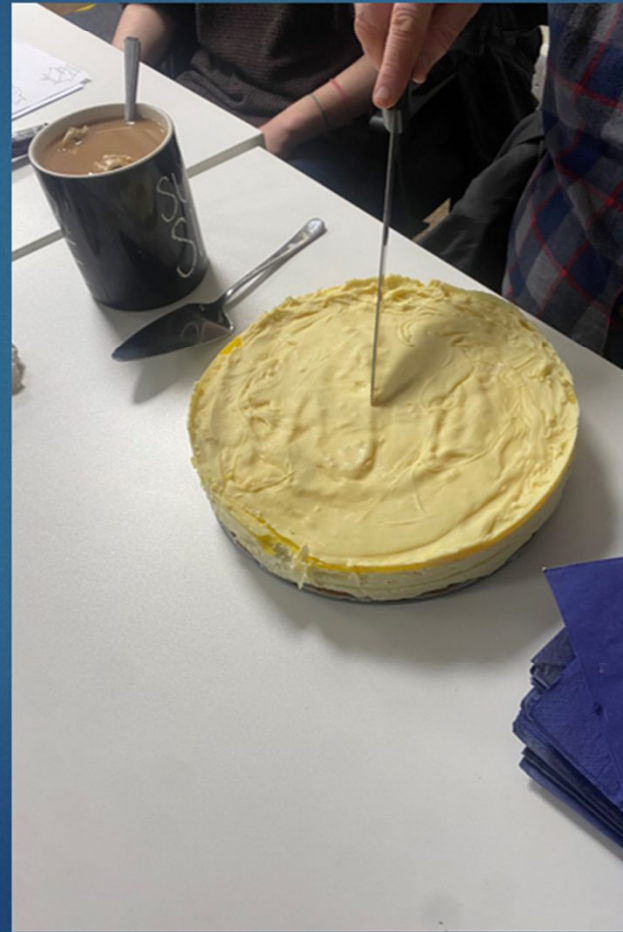



# What people have said about us.....

Night light café is a warm and friendly environment filled with great people.

Safe, welcoming, friendly, just brilliant.

I was in a dark place when I heard about the night light café when I decided to give it a try. I was warmly welcomed and made to feel at ease by everyone and felt comfortable enough to take part in the activities on offer.

The banter.

I can't remember the last time I laughed so much if at all, my cheeks are still hurting.

# What the volunteers have said about us.....

Knowing you have  
a put a smile on  
someones face for  
even just 3 hours  
makes me happy.

Donating time and  
energy to others can  
take you out of yourself  
and can make you feel  
better too.

Volunteering has  
improved my own  
mental health  
without even  
realising.

Knowing that you have  
been there for someone  
to help and support and  
listen to them is very  
rewarding.





**Monday Night –  
Connexions – Chill,  
chat, connect.  
100 Church Street.  
(Opposite Parish  
Church)**

**Thursday Night –  
Riverside Training.  
Market Street.  
(Above the post  
office)**





Food Bank

# Salvation Army Food Bank

---

## Gainsborough Salvation Army Food Bank 2023 Statistics

### Total Number of People Fed Each Month

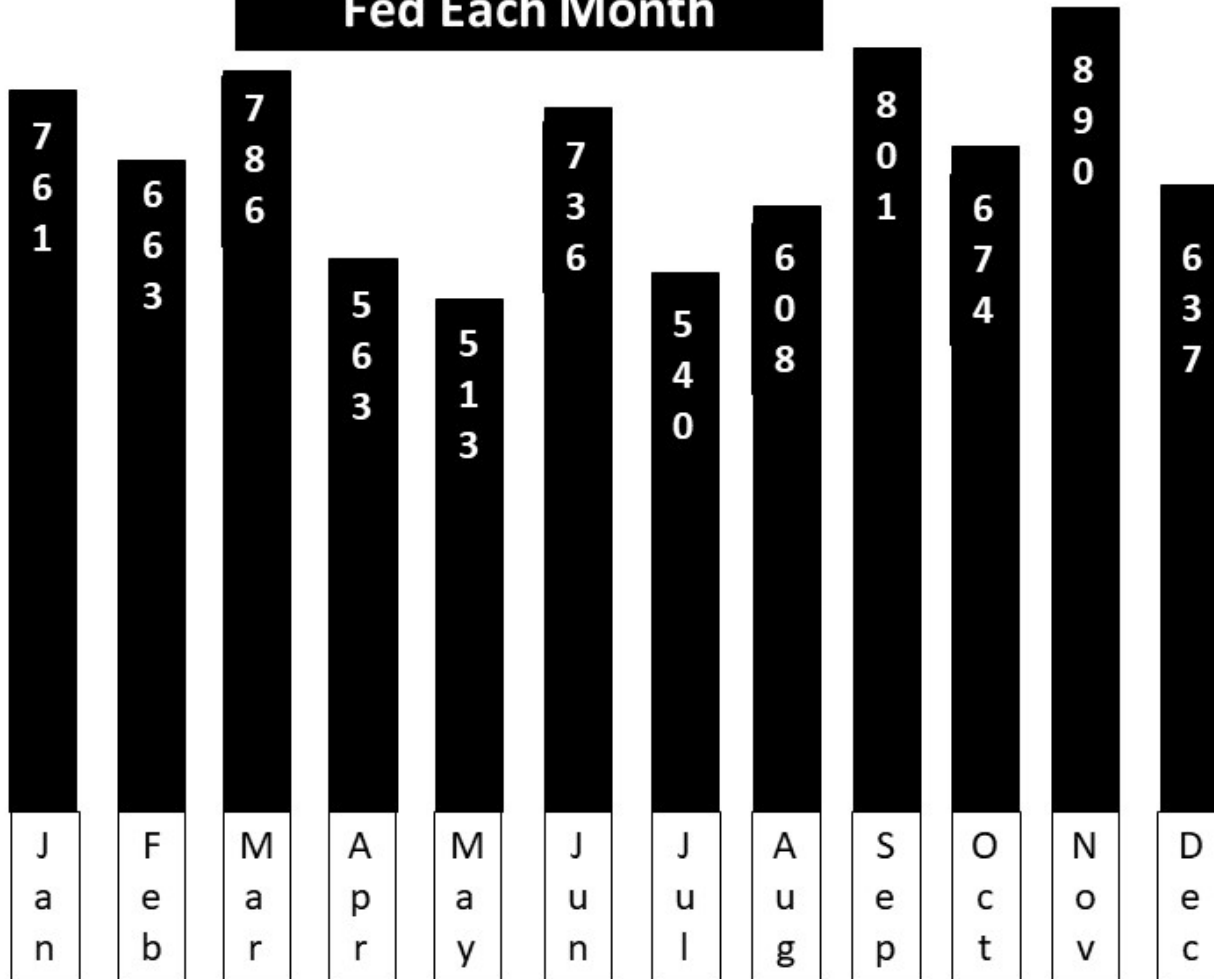

Total number of people for year = 8172

Highest number of people in a month = 890

Highest number of people in a week = 236

Total cost in food (x £5 per person) = £40,860

Yearly spend on food = £30,000

Donated Food cost = £10,860

approximate breakdown of people coming to our food bank

Pensioners = 50%

Low Paid  
25%

Unemployed  
25%

**shaw  
trust**

**Shaw Trust**

---



Work and Health Programme

WHP **Pioneer**



# Aim of the programme's

- **Work and Health programme has been in operation since 2018 with the emphasis on supporting unemployed individuals to overcome barriers to find sustainable employment.**
- **Pioneer is based on the concept of Place, Train and Maintain. This means we place people in work at the earliest opportunity, prepare them to be trained to do the job in the way the employer wants it done, and provide ongoing support to maintain them in the job.**

# Facts and Figures

- In 2023 we supported 678 participants back into employment
- From January – March 2024 we have supported 185 participants back into employment

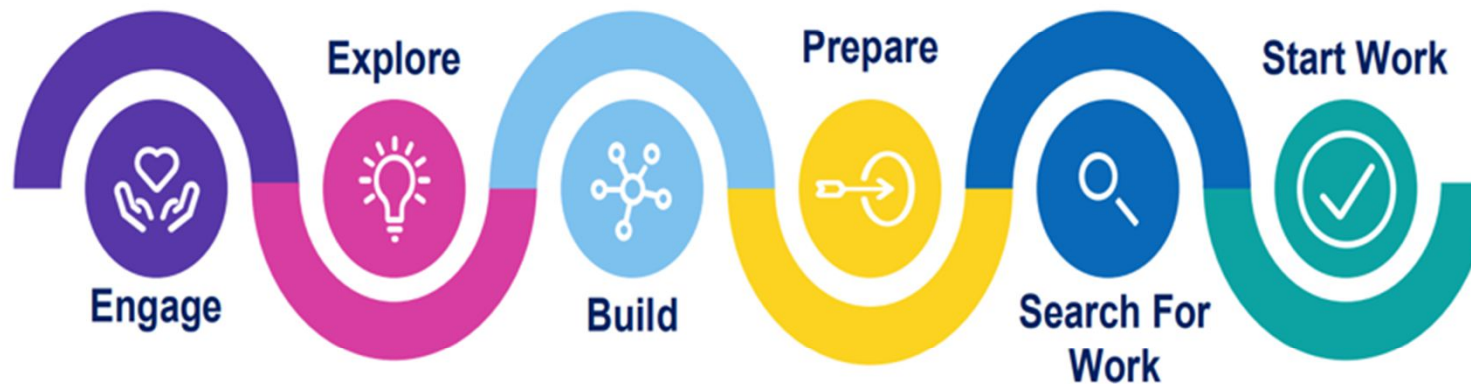

# How do the programmes operate?



- Referral
- Contact from our CST Team
- Welcome Call
- Start Meeting
- Initial Assessment
- Formal Review Meetings
- In work support
- Exit

# Benefits

- ✓ A personalised 15 month tailored programme
- ✓ Access to employers
- ✓ Health and Wellbeing team to support, plus lots of health interventions
- ✓ Job specific CV and cover letter creation.
- ✓ Mock interviews and interview prep.
- ✓ Confidence building
- ✓ Access to digital careers platform.
- ✓ Opportunities to learn new skills and gain accredited qualifications.
- ✓ Sign posting support
- ✓ Self-employment guidance
- ✓ Better-off in work calculation.



# Training/ Upskilling Opportunities



- Green CSCS Card
- Customer Service
- FLT
- SIA
- ICT – Basic to Level 2
- Food Hygiene Certificate
- Business Admin
- Bookkeeping
- Teaching Assistant
- Maths & English
- Employability

# Self-Employment Support

- **Participants will receive comprehensive self-employment and business mentoring support including:**
  - **A Business Plan document, Cashflow Forecast and Personal Survival Budget to support their new enterprise**
  - **Offer to attend Marketing and Financial Seminars and attendance to networking events**
  - **6 months sustainment support, includes ongoing support from a Business Mentor.**
  - **Loan and funding advice where applicable**
  - **Help with Registering with HMRC, e.g., obtaining UTR Number**
  - **Participants will be required to provide evidence of continued trading at various points throughout the 6 months**



# Employment Engagement Specialists

**Direct Links to employers and local vacancies**

**Work with our National Accounts team who have numerous opportunities with many high street names**

**Employer support through our EES can be a faster track back into employment.**

**Organise Sector Based Work Academies for our participants as well “Employer in the hub events”**



# Additional Support

## Expert Volunteers

- **Managing anxiety,**
- **Employment related activities,**
- **Mental health support,**
- **IT training**
- **Confidence building.**
- **Interview using the STAR technique**



## Support Manager Group Sessions

- **Power Hour job clubs**
- **Health and Wellbeing**
- **Get into events**
- **Warm Spaces**
- **Breakfast Clubs**



# Eligibility & Referral Process

- **Must not be in any form of paid employment**
- **Must not have been on the programme before**
- **Must be in a position where they are ready to look for work in the next 12 months**
- **Have a disability/ health condition or be part of the Early Entry Criteria**
- **Must have access to government funds.**



# Early Access criteria groups

11

- an ex-offender (someone who has completed a custodial sentence or a community sentence), or offender (someone who is serving a community sentence)
- a carer
- an ex-carer
- a homeless person
- a former member of His Majesty's (HM) Armed Forces
- a member of the HM Armed Forces reserves
- a partner of current or former Armed Forces personnel
- a person for whom a drug/alcohol dependency (including a history of) presents a significant barrier to employment
- a care leaver
- refugee
- young people identified as being involved or at risk of being involved in gangs or serious violence
- victims of domestic violence
- Afghan Resettlers
- Ukrainian Evacuees

## How you refer:

Please contact:

E: [james.trafford@shaw-trust.org.uk](mailto:james.trafford@shaw-trust.org.uk)

T: 07872 860 052

Or visit: [www.shawtrust.org.uk/whp-pioneer/](http://www.shawtrust.org.uk/whp-pioneer/)

- Name
- Address
- Telephone
- National Insurance



# Gainsborough Changing Places

---



**MUSCULAR  
DYSTROPHY  
UK** | OUR MUSCLES  
MATTER

## Changing Places Toilets



**Gainsborough Changing Places  
Campaign**



In the UK more than 300,000 individuals require **Changing Places toilets** for their everyday care.

These specialised toilets go beyond standard accessibility, offering essential features like hoists, adult-sized changing benches, and extra space for carers.

However, the reality remains concerning: there are only 2299 changing places toilets nationwide. In some areas access to these vital facilities are none existent, posing significant challenges for individuals with disabilities and their care givers.

**There are no registered Changing Places toilets Gainsborough or in West Lindsey.**



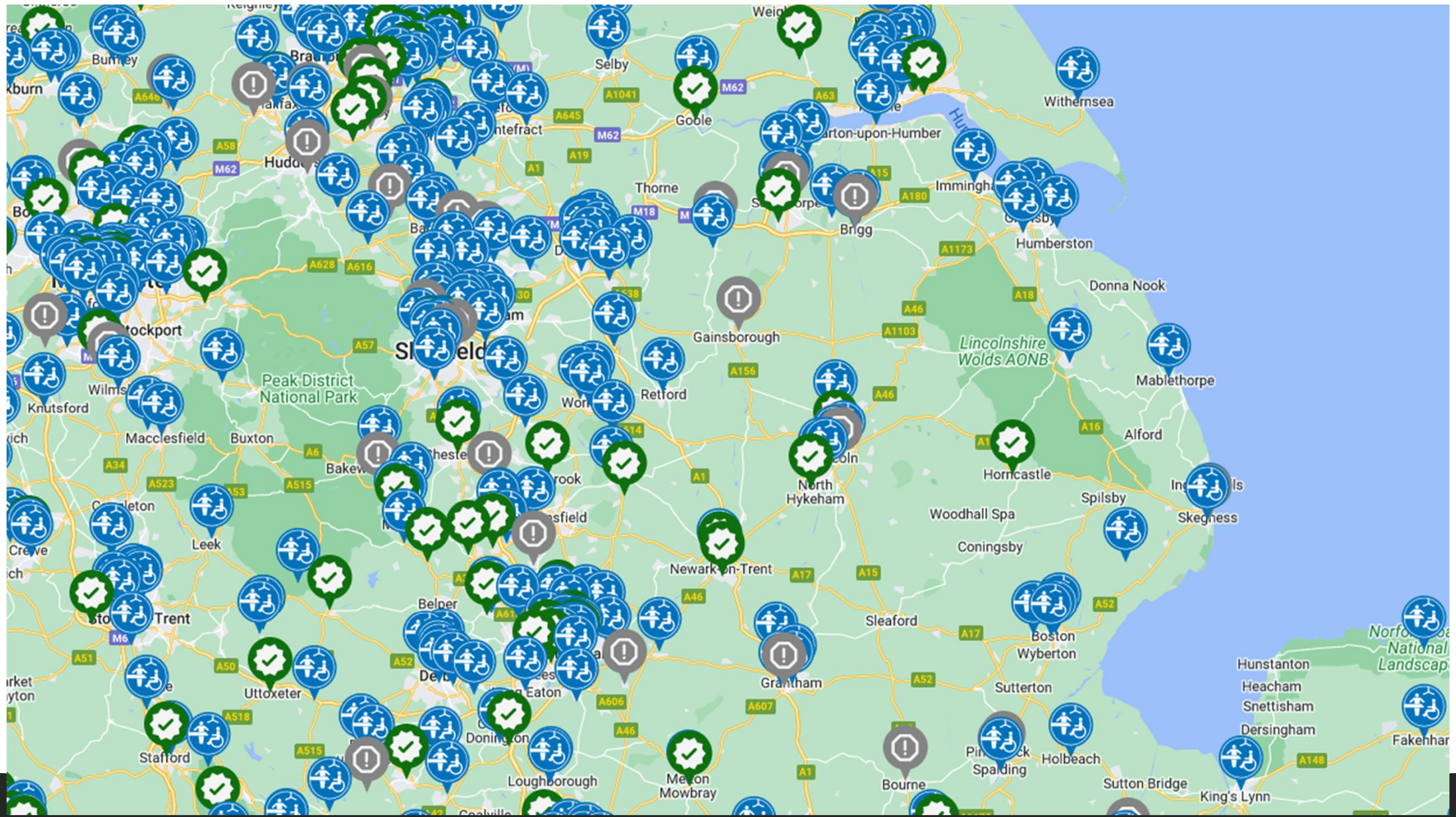





# Changing Places Toilets

## What is a Changing Places Toilet?

- Changing Places Toilets are different from, and needed in addition to, standard accessible toilets because they meet the needs of different people.
- CPTs are essential for over 300,000 people in the UK.
- A CPT is more than an accessible toilet because it provides:
  - An adult-sized, height-adjustable changing bench
  - A hoist (mobile or ceiling track)
  - A peninsular toilet and washbasin
  - A privacy screen
  - More space; 12 metres squared
- If you are considering a CPT installation, or you need any guidance, drop us a line at our email address: [cpt.support@muscular dystrophyuk.org](mailto:cpt.support@muscular dystrophyuk.org)
- Or better still, speak to us today!







## **Who are they for ?**

Thousands people with profound and multiple learning disabilities as well as other disabilities that severely limit mobility.

People may be limited in their mobility so need support from one or two carers to either get on to the toilet or have their continence pad changed.

Without Changing Places toilets, the person with disabilities is put at risk, and families are forced to risk their own health and safety by changing their loved one on a toilet floor..... or avoid going out at all.











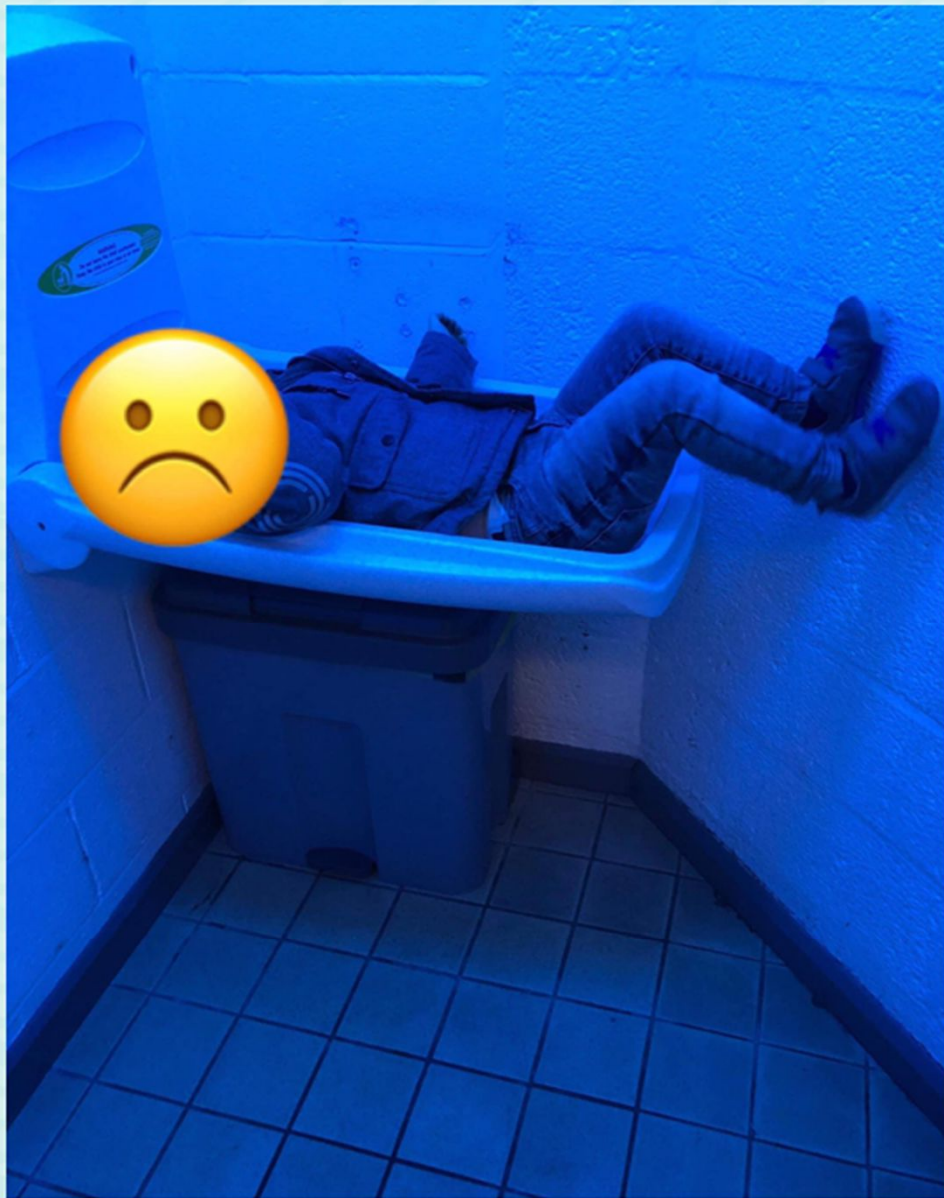



## Changing Places Toilets

### Building Regulations – Statutory CPT Installation Requirements

Building Type	Capacity or area
Assembly, recreation and entertainment	350 persons or more
Ditto, but being within a collection of smaller buildings <i>Example: zoos, theme parks, venues for sport &amp; exhibitions</i>	2,000 persons or more
Shopping centres/malls or retail parks	30,000 m <sup>2</sup> gross floor area or more
Retail Premises	2,500 m <sup>2</sup> gross floor area or more
Sport & Leisure	More than 5,000 m <sup>2</sup> gross floor area
Hospitals & primary care centres	n/a
Crematoria and cemetery	n/a

### The Legislative Context

**Duties and responsibilities of providers, employers and rights of users.**

- Equality Act 2010 and Public Sector Equality Duty
- United Nations Convention on the Rights of Persons with Disabilities
- ADM Building Regulations
- Best Practice BS8300
- Our Changing Places Practical Guide



# WLDC Corporate Plan 2023 >2027

## Core values

Putting our customers at the centre of everything we do.

Objective - Deliver high quality customer centric services that offer an excellent customer experience.

Outcome -The right resources in place **to support vulnerable customers and those with complex needs.**



# **Equality Diversity and Inclusion Policy**

Our vision is to make West Lindsey a better place to live, work, invest and visit. Understanding that communities in the district have diverse needs is fundamental to our capacity to deliver services to suit everybody and we are committed to equality, diversity and inclusion in both employment practice and service delivery.

“We will ensure a commitment to equalities and diversity in our commissioning and procurement arrangements and expect suppliers and contractors to fully comply with this equalities and diversity policy.”

# The 'Gains' from installing Changing Places Toilets in Gainsborough

1. Access for all, dignity and inclusion.
  2. Accessible Tourism.
3. Harnessing the power of the purple pound.
  4. Improving mental health and wellbeing.
  5. Playing an active part in the community.
    6. Access to employment.





## Changing Places Toilets

### Changing Places Consortium – What do we do?

- Work on Government funded programmes – MDUK only
- Website Resources
  - Our CPT map and journey planner
  - Campaigning resources
  - Changing Places Practical Guide
  - Learning from others – Our Case Studies & Testimonials
- Bespoke training in conjunction with our partners, and fellow Consortium members, CAE
- Provide guidance and checking of draft plans to ensure compliance
- Connecting Local Authorities, venues, equipment providers, suppliers, campaigners and users
- CPT registration, promotion and publicity
- 4 social media channels: Twitter: [@changingplaceuk](https://twitter.com/changingplaceuk) Facebook: Changing Places UK  
 LinkedIn: Changing Places UK Instagram: [@ChangingPlacesUK](https://www.instagram.com/ChangingPlacesUK)

### Where are the most Popular Locations for a CPT ?

- 1: Beaches / seaside / country parks / open spaces 2: Parks / gardens  
 3: Motorway services 4: Visitor attractions 5: Zoos/safari parks



**MUSCULAR  
DYSTROPHY  
UK** | OUR MUSCLES  
MATTER

**Changing  
Places Toilets**

**Thank You**



**BEARDED**

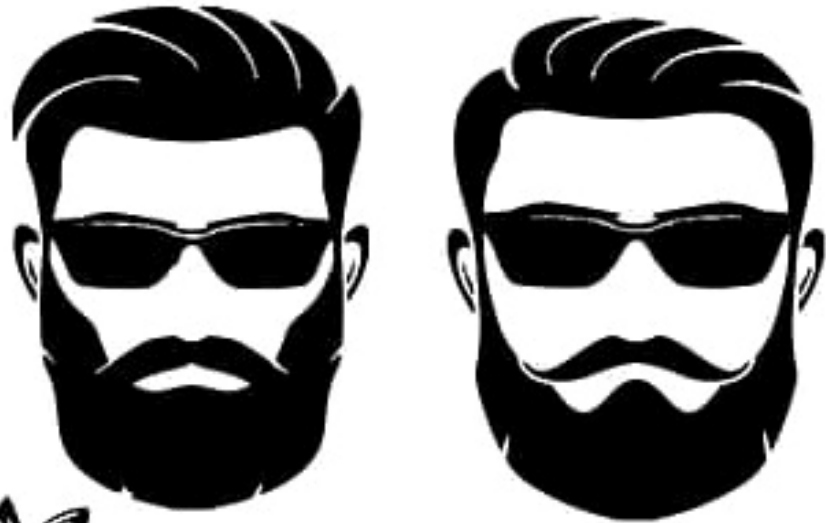

Bearded  
Fishermen

---



**FISHERMEN**

# Open Forum

---



**Thank you for attending**

---